

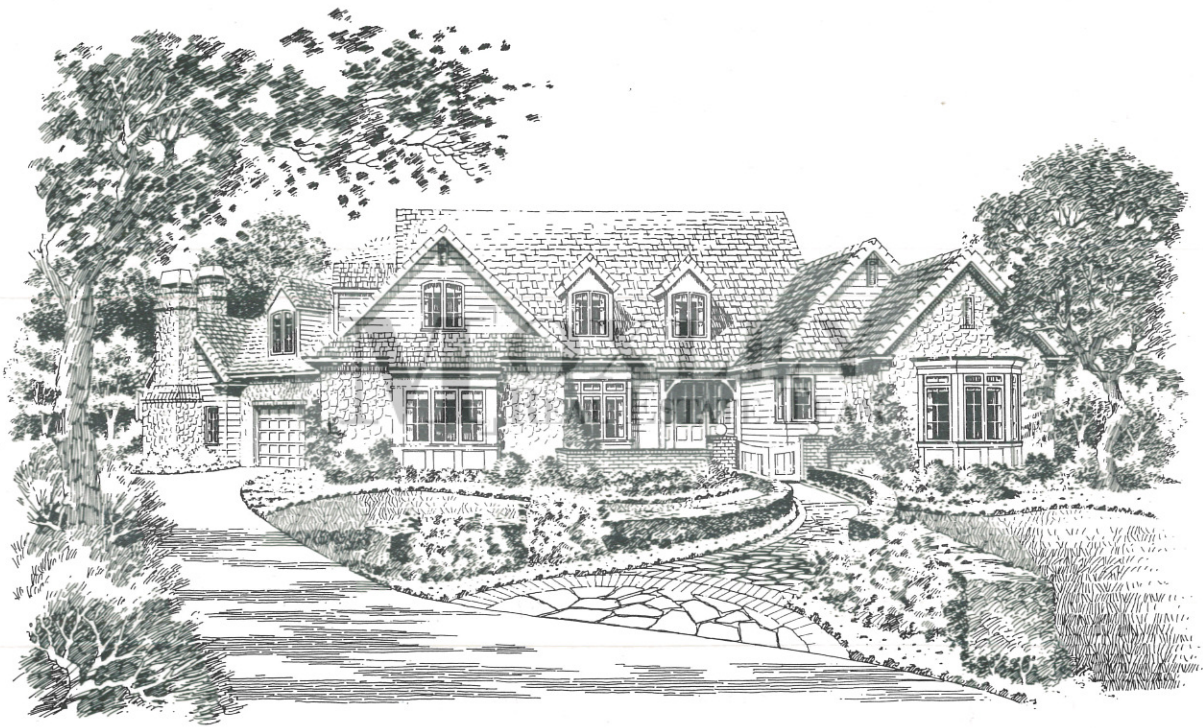

PACIFIC BAY CONSTRUCTION



673 VARESE COURT

FRENCH COUNTRY

—FEATURED BUILDER—

FLOOR PLAN

5 Bedrooms • 4 Baths • 2 Half Baths
Two 2-Car Garages

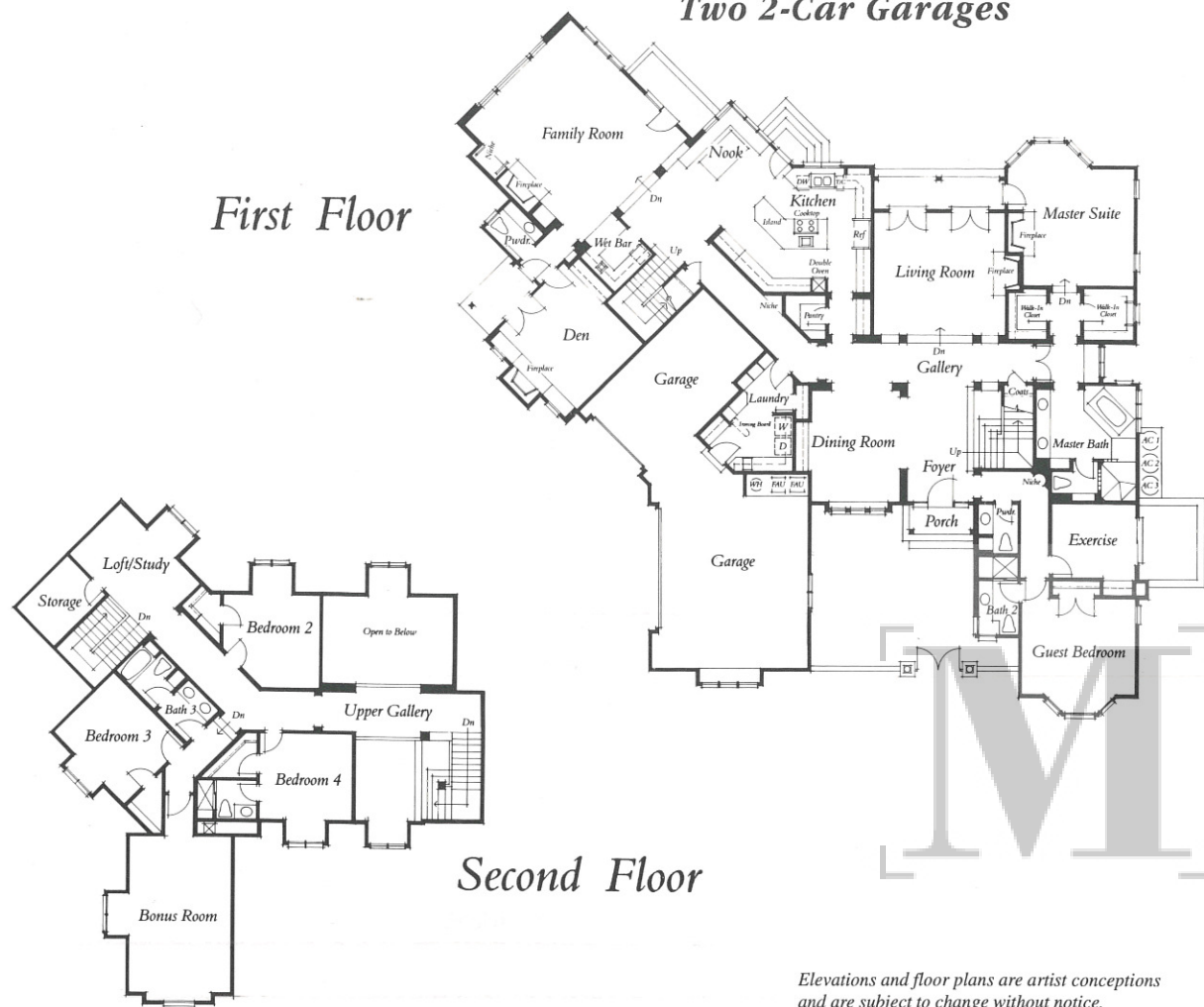

Elevations and floor plans are artist conceptions and are subject to change without notice.

Come home to casual French Country living. A spectacular quarry stone exterior compliments this quiet setting. The gated front entryway is surrounded by gardens. Step inside to detailed woodworking and a gourmet kitchen with traditional banquette seating. Enjoy the privacy afforded you with the main floor master suite and the guest / au pair quarters in a separate area. Upstairs you will find three spacious bedrooms and a private loft for play area. This distinctive residence offers that casual elegance you've been looking for.

FEATURES

DISTINCTIVE EXTERIORS

Elegant French traditional styling
 Quarry stone and heavy mortar finish with wood siding
 Hand-carved, French-style mahogany entry system with diamond leaded sidelights
 Wood casement windows
 Three-car garage

DRAMATIC LIVING AREAS

Extensive volume ceilings
 Staircase crafted from stained mahogany with painted balusters and carpeting up the center
 Spacious living room with wood-burning fireplace
 Formal dining room with built-in linen niche for sideboard or buffet, wainscoting and hardwood flooring
 Sunken family room with wet bar, refrigerator and ice maker, wine cooler, Ise H2O hot water dispenser, entertainment station and slate flooring
 Stone fireplace in family room with heavy mortar and wood box
 Upper gallery overlooking formal living room
 Library with separate entrance, slate floor, wood-burning fireplace and paneled mantel and surround
 Loft/study on second floor features a desk niche and generous closet storage

WELL-APPOINTED KITCHEN

Thermador six-burner gourmet range
 Work island with seating
 French country cabinetry with painted finish
 Kohler vegetable sink
 Kohler two-bowl sink with French style faucet
 Two Kitchen Aid dishwashers
 Kitchen Aid trash compactor
 Ise H2O instant hot water dispenser
 Kitchen Aid refrigerator with 48-inch freezer

WELL-APPOINTED KITCHEN (continued)

General Electric double self-cleaning ovens including convection
 General Electric microwave oven
 Hardwood flooring
 Built-in desk
 Butler's pantry with six-lite French-style cabinet doors
 Breakfast nook with built-in banquet seating, wainscoting and view to backyard

LUXURIOUS MASTER SUITE WITH BATH

Grand double entry doors to suite
 Private octagonal retreat
 Wood-burning fireplace with painted mantelpiece
 Private entrance to deck
 Double closets with cedar stripping
 Jetted tub
 Walk-in shower with glass block surround
 Double vanity and make-up station
 Private commode area
 French style tile

EXCEPTIONAL DESIGN AND CONSTRUCTION FEATURES

Gym with wet-bar, tile countertop and mirrored wall
 Formal powder room with tile vanity, wainscoting, built-in linen and hardwood flooring
 Private guest/au pair quarters with bath
 Kitchen bath with tile vanity and slate flooring
 Laundry room with utility sink, sewing station, generous storage lockers, linen closet and tile counter and flooring
 Builder reserves the right to make product changes and/or modifications without prior notice.

For further information, contact:

Ruby Hill Information Center
 2001 Ruby Hill Boulevard, Pleasanton, CA 94566
 (510) 417-2250 Fax (510) 417-8586

