



# ORION HOMES, INC.



*624 VARESE COURT*

MEDITERRANEAN

—FEATURED BUILDER—

## FLOOR PLAN

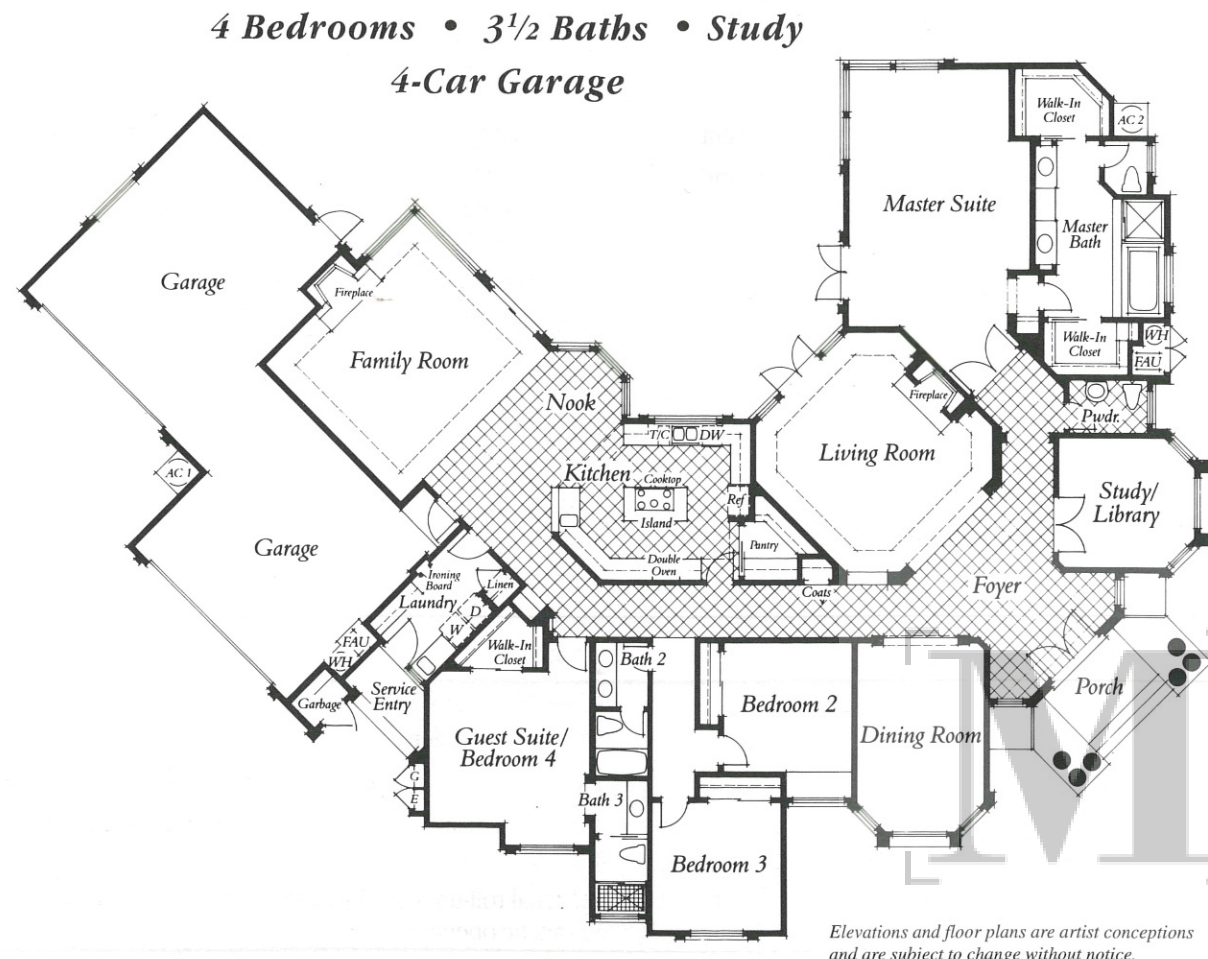

*This single-level estate home conveys a feeling of prestige and substance. The dramatic entry with its soaring volume opens onto the formal living and dining rooms and a library/study. The kitchen is designed as a hub for family activity with superbly organized work areas opening onto casual living and eating areas. The master bedroom suite is designed as a private living area. High ceilings and picture windows in the sitting area draw the eye outward to the expansive yard and bring a high level of visual appeal to this private domain.*

## FEATURES

### WELL APPOINTED KITCHEN

- Kitchenaid 30" double oven with thermal-convection upper oven
- Kitchenaid full size built-in microwave
- General Electric 5 burner gas cooktop with downdraft vent
- Kitchenaid Supurba dishwasher with Whisper Quiet sound reduction system
- Kitchenaid solid pack trash compactor
- Raised panel white painted cabinets with melamine interiors, European hinges, spice rack, and pull-out trays
- Recessed and undercounter lighting
- Walk-in pantry
- 12 inch x 12 inch ceramic tile flooring
- Sandstone Corian countertops with elegant bullnose edging
- Kohler Executive Chef sink with Kohler Provence pull-out spray faucet, ISE hot water dispenser and liquid soap dispenser
- Kohler Portofino vegetable/bar sink with Delta gooseneck faucet
- Sunny breakfast nook with bay window

### LUXURIOUS MASTER SUITE AND BATH

- Double door entry
- His-and-hers walk-in closets with single and double shelves and poles
- Six foot soaking tub with ceramic tile surround
- Separate shower with clear glass enclosure framed in polished brass with ceramic tile surround
- Full width beveled vanity mirror over tiled vanity with double Kohler china basins
- Polished brass Kohler faucets
- Frameless beveled mirror medicine cabinets
- Kohler water saving toilet
- Raised panel natural stained maple cabinets

### FINE CONSTRUCTION FEATURES

- Double eight-foot entry doors with polished brass Baldwin hardware and security deadbolt
- Polished brass lever-style interior hardware with privacy locks at all bedrooms and baths
- Concrete Espana tile roof
- Woodburning livingroom fireplace with precast concrete face

### FINE CONSTRUCTION FEATURES *(continued)*

- Woodburning familyroom fireplace with brick face
- Garage interior taped, textured and painted with built-in workshop cabinets
- Interior laundry room with utility basin and service entrance to outside
- Interior rounded corner wall details at outside walls, windows and ceiling details
- Bronze anodized aluminum windows with dual glazing
- Wood patio and sliding French doors
- Prewired for telephone and cable television in all bedrooms

### CONVENIENCE & ENERGY SAVING FEATURES

- Two central air conditioners
- Two energy-efficient furnaces with automatic setback thermostats
- Smoke detectors and automatic fire sprinklers throughout living areas, garage and attic areas
- Weather stripped windows and exterior doors
- Water-saving toilets
- Two 50-gallon water heaters with insulated hot water pipes
- Two attached double garages with direct access to interior of home
- Sectional roll-up metal insulated garage doors with automatic openers

### CUSTOM DETAILS

- Central vacuum system
- Electronic security system
- Clear glass tub enclosure in secondary bath
- Front yard landscaping

Builder reserves the right to make product changes and/or modifications without prior notice.

For further information, contact:

Ruby Hill Information Center  
2001 Ruby Hill Boulevard, Pleasanton, CA 94566  
(510) 417-2250 Fax (510) 417-8586





# ORION HOMES, INC.

## PLEASANTON

*Our company believes that each home and each site can be extraordinary, a unique reflection of those who reside within. Orion Homes was established in 1968, with architectural contributions to the historic Livermore valley going back to 1962. Custom residences by Orion Homes are designed and built by a team of specialists experienced in working with sophisticated, discerning clients. Our company's success is firmly rooted in customer satisfaction. Our goal is excellence in design, innovation, quality and value.*

*Kenneth Orion Gooch*

*Architect/Builder*