



# CLOUSTON CONSTRUCTION, INC.



*656 VARESE COURT*

MEDITERRANEAN

—FEATURED BUILDER—

## FLOOR PLAN

**5 Bedrooms • 4 Baths • 2 Powder Rooms**  
**Game Room • 3 Car Garage**

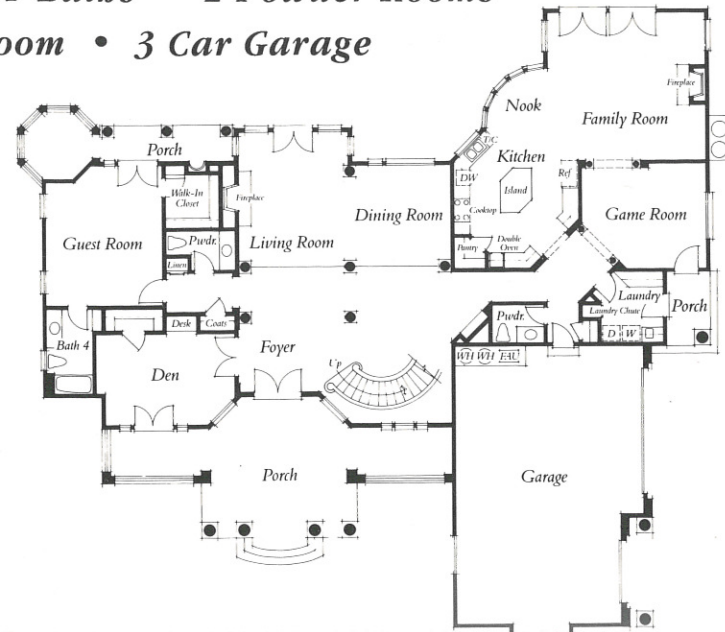

*First Floor*



*Second Floor*

*Elevations and floor plans are artist conceptions and are subject to change without notice.*

*This expansive villa is artfully embellished with Mediterranean details: white columns, rounded windows, concrete railings and an authentic clay roof. The marble foyer showcases an elegant fully suspended staircase. Abundant windows and glass doors open the home to spectacular golf course views. Hand-crafted touches such as built-in entertainment centers in the family room and master suite, custom cabinetry and crown moldings are found throughout. The master bath features a platform tub surrounded by columns - a statement in luxury.*

## FEATURES

### DISTINCTIVE EXTERIORS

Elegant Mediterranean styling

Authentic clay roof

Grand entry supported by massive 16-inch concrete columns

Immense 9-foot solid oak front doors, 2½-inches thick with polished brass hardware and custom stained-glass inserts

Designer concrete driveway

Three-car garage with sectional doors and automatic door openers

### ELEGANT LIVING AREAS

Grand limestone and marble foyer with unique fully suspended curved staircase

Dramatic volume ceilings

Abundant dual-glazed windows with wood casings

True French doors opening to terraces directly on the golf course

Extensive crown moldings, wainscoting and turned columns, handcrafted by Bob Clouston

Granite-faced oversized fireplaces with log lighters in living and family rooms

Custom built-in oak cabinetry in library and exercise room

### WELL-APPOINTED KITCHEN

Custom oak cabinetry with deep crown moldings

European-style hinges with raised panel doors and pull-out trays

Solid slab granite countertops with full 1½-inch bullnose detail

Five-burner gas cooktop with concealed pop-up vent by General Electric

General Electric 30-inch double ovens with upper convection

Top-of-the-line Bosch dishwasher with raised oak panel

General Electric trash compactor with raised oak panel

Large gourmet cast-iron sink with KWC pull-out faucet and instant hot water dispenser by ISE

Spacious walk-in pantry

Oak floor

Sunny breakfast nook overlooking the golf course

### SPACIOUS MASTER SUITE WITH RETREAT AND BATH

Grand double door entry

Private sitting room and terrace directly on golf course

Fireplace with log lighter surrounded by built-in oak bookshelves and entertainment center

His and her walk-in clothes and linen closets

Large Roman whirlpool tub on raised marble platform surrounded by columns

Oak vanity with double sinks and marble countertop

Separate marble and glass shower

Polished brass faucets and fixtures

### ADDITIONAL CONVENIENCES

Conveniently located laundry room with unusual laundry chute and outside entrance

Telephone and cable television prewired in all bedrooms

Central vacuum system

Electronic security system

Intercom system

Two air conditioners and furnaces

Automatic fire sprinklers

Two 50-gallon water heaters with re-circulation system

Builder reserves the right to make product changes and/or modifications without prior notice.

For further information, contact:

Ruby Hill Information Center  
 2001 Ruby Hill Boulevard, Pleasanton, CA 94566  
 (510) 417-2250 Fax (510) 417-8586





# CLOUSTON CONSTRUCTION, INC.

## LIVERMORE

*Clouston Construction, Inc. is a family-owned and operated company established in 1984. Robert is a third-generation builder specializing in cabinetry and finish wood work; Brenda is a licensed real estate agent. Together they collaborate on design, construction and marketing. Their custom homes are always located on choice homesites and feature elegant design touches and woodworking craftsmanship that set them apart. Clouston Construction, Inc. believes your custom home is the single most important purchase you'll ever make. "We will go to great lengths to insure that your home is perfect in every single quality detail."*

*Robert Clouston*

*Owner*



SYCAMORE GROVE PARK

KURTZER RANCH

CROHARE RANCH

ARROYO DEL VALLE

THOMAS COYNE WINERY

FENESTRA WINERY

KALTHOFF VINEYARDS

FOLEY RANCH

VINEYARD AVENUE

VALLECITOS ROAD

ISABEL AVENUE

ROUTE 84

EAST GATE RUBY HILL

